

*komfovent*<sup>®</sup>

DOMEKT

Smart  
Home Comfort



# Range review

## Energy saving

- Modern energy efficient EC fans.
- High efficiency rotary exchangers.
- High efficiency counterflow plate heat exchangers.
- High filtration class and low resistance air filters.

## Design

- Minimalist design.
- Airtight doors. Locks without thermal bridges. Ergonomic handles.
- Plastic duct connections ensure better tightness and reduce thermal bridges.
- Additional duct connection is intended for the short-term removal of polluted air from the stove or sanitary rooms.

## Smart control

- "Komfovent Control" app.
- Ability to control via a web browser.
- Integration into a smart home management system.
- Demand control ventilation according to the air quality parameters by connecting additional sensors.

## Casing technology EPP (expanded polypropylene)

- No thermal bridges, no condensation.
- Improved thermal insulation.
- Better aerodynamics.
- Reduced weight.
- Hydrophobic.
- Applied to DOMEKT R 300 V, CF 200 F, CF 200 V, CF 300 V.

## Reliability and durability

- The housing of the units is made of galvanized steel with a powder coated finish.
- Fan motors are protected from humidity and dust, and equipped with long-life bearings.

## Low noise level

- Perfectly balanced fans.
- All of the unit's components are aerodynamically matched.
- The casing is insulated with mineral wool and special composite materials.

### Domekt R | with rotary heat exchanger

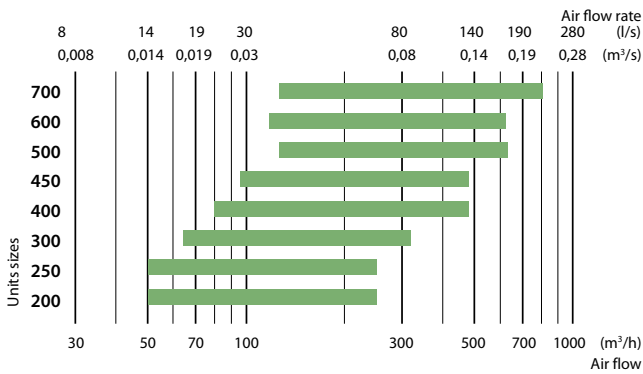

### Domekt CF | with counter flow heat exchanger

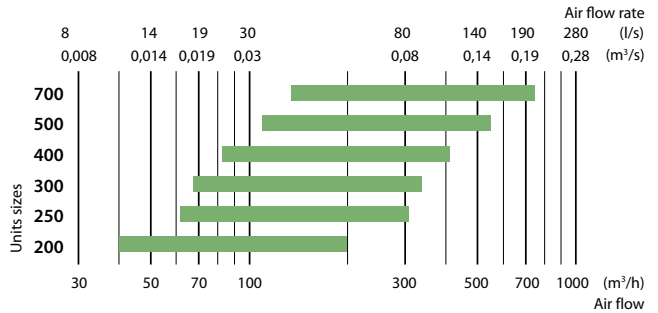

### Domekt S | supply air handling unit

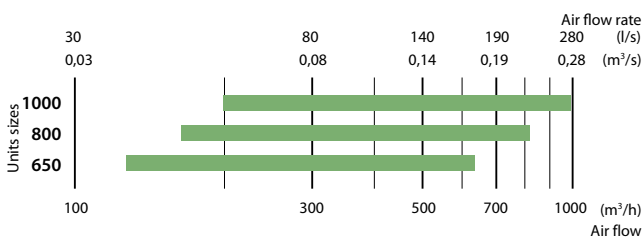

## Rotary heat exchangers

### Operating principle

The rotary heat exchanger transfer effect is based on the accumulation principle – the rotating aluminium wheel with small channels is warmed up by extract indoor air and then the heat is transferred to the outdoor intake. At low temperatures, humidity from extract air condensates on the rotor surface and humidifies the outdoor intake air, where absolute humidity in winter is always too low to provide comfortable conditions. Therefore, such rotary heat exchangers are called condensing.

### Advantages

- Efficiently recovers the heat even the outside temperature drops to -30°C.
- Efficiently recovers cold during the summer and reduces conditioning costs.
- Recovers the humidity in the room while maintaining the optimal comfort level.
- Advanced design ensures minimal mixing of air flows.
- No drainage is necessary – easy unit installation.
- No primary heater as the heat exchanger does not ice.

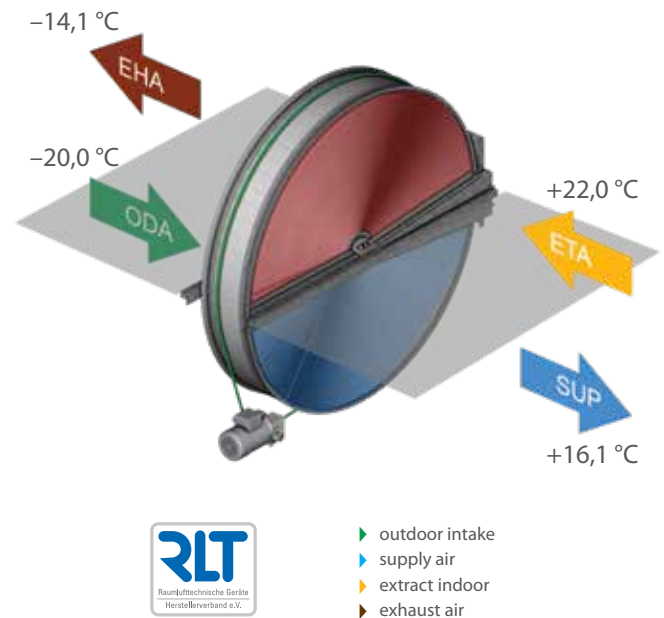

## Sorption rotary heat exchanger – the highest comfort

### Advanced energy saving technology

The latest improvements have been adapted in sorption rotary heat exchangers. The surface of the rotor has a zeolite coating, which improves the humidity exchange up to 90%, so this rotor effectively recovers humidity – humidifies the supply air in the winter and dries it in the summer. The optimal comfort is maintained all year long.

### Advantages

- Reduced demand for air conditioning power.
- Reduced demand for air humidification and dehumidification power.
- More efficient use of passive cooling.

### Indoor climate comfort zones of premises

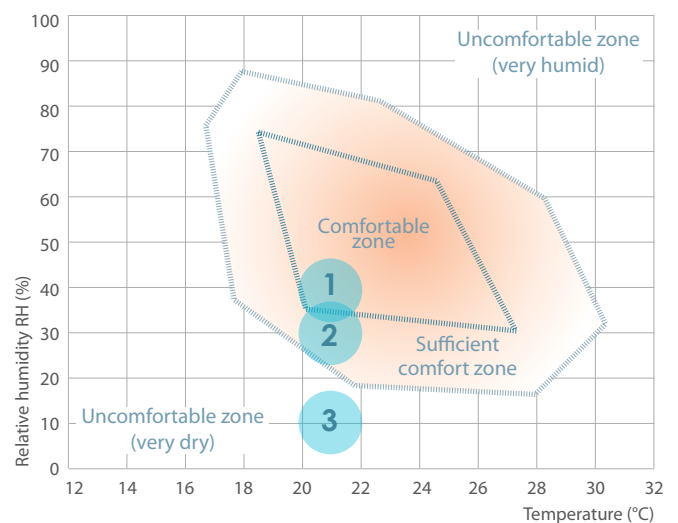

Parameters of equipment with different heat exchangers in winter:

- 1 Sorption rotary heat exchanger
- 2 Enthalpy counterflow plate heat exchanger
- 3 Counterflow plate heat exchanger

# Domekt R

## Air handling units with rotary heat exchanger

### Sizes and air volumes of Domekt R units

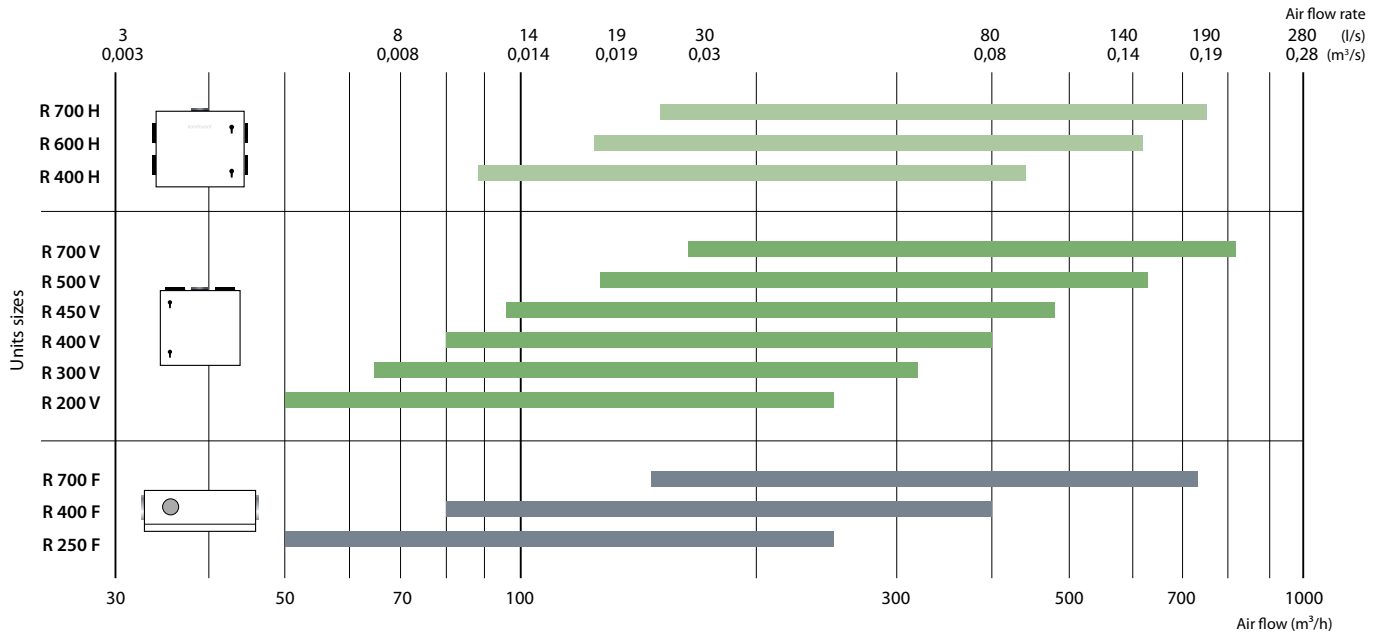

### Modifications of Domekt R units

Unit	Heat exchanger		Supply/exhaust air filter class		Heater			Cooler		Inspection side				Control system		
	L/A	L/AZ	F7	M5	HE	DH	H CW	H CW	H CDX	R1	R2	L1	L2	C4	C6	C6M
Domekt R 200 V	●		○	●	●	△	△			○		○		●		
Domekt R 250 F	●	○	○	●	●	△	△	△	△	○	○	○	○		●	
Domekt R 300 V	●	○	○	●	●	△	△	△	△	○		○			●	
Domekt R 400 V	●	○	○	●	●	△	△	△	△	○		○				●
Domekt R 400 H	●	○	○	●	●	△	△	△	△	○		○				●
Domekt R 400 F	●	○	○	●	●	△	△	△	△	○	○	○	○			●
Domekt R 450 V	●	○	○	●	●	△	△	△	△	○		○				●
Domekt R 500 V	●	○	○	●	●	△	△	△	△	○		○			●	
Domekt R 600 H	●	○	○	●	●	△	△	△	△	○		○				●
Domekt R 700 V	●	○	○	●	●	△	△	△	△	○		○				●
Domekt R 700 H	●	○	○	●	●	△	△	△	△	○		○				●
Domekt R 700 F	●	○	○	●	●	△	△	△	△	○	○	○	○			●

● standard equipment  
 ○ possible choice  
 △ ordered separately duct heater/cooler

The markings are explained on p. 7.

# Domekt R 200 V C4

Maximal air flow, m <sup>3</sup> /h	236
Maximal air flow, l/s	66
Unit weight, kg	42
Supply voltage, V	1~230
Maximal operating current, A	HE5,2
Thermal efficiency of heat recovery, %	81
Reference flow rate, m <sup>3</sup> /s	0,05
Reference pressure difference, Pa	50
SPI, W/(m <sup>3</sup> /h)	0,31
Filters dimensions B×H×L, mm	285×130×46
Electric power input of the fan drive at reference flow rate, W	24
Electric power input of the fan drive at maximum flow rate, W	63
Electric air heater capacity, kW / Δt, °C	0,8/ 13,4
Maintenance space, mm	300
Control system	C4

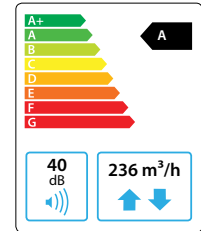

## Acoustic data

A-weighted sound power level  $L_{WA}$ , dB(A) at reference flow rate

Supply inlet	52
Supply outlet	65
Exhaust inlet	53
Exhaust outlet	65
Casing	40

A-weighted sound pressure level  $L_{pA}$ , dB(A)

10 m<sup>2</sup> normally isolated room, distance from casing – 3 m.

Surroundings	30
--------------	----

## Temperature efficiency

Outside temperature, °C	Winter					Summer		
	-23	-15	-10	-5	0	25	30	35
After heat exchanger, °C	13,4	14,9	15,9	16,8	17,8	22,6	23,5	25

indoor +22°C, 20 % RH

Shown as left (L1)

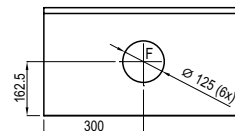
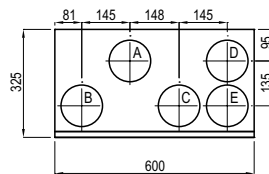
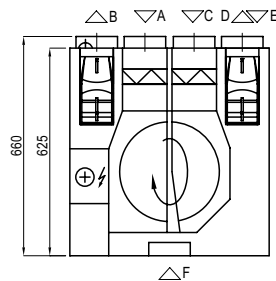

Shown as right (R1)

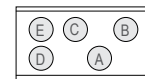

- A outdoor intake
- B supply air
- C extract indoor
- D exhaust air
- E additional extraction connection (by-pass – extraction without heat recovery)
- F kitchen hood connection (by-pass – extraction without heat recovery)

## Performance

Unit with standard equipment

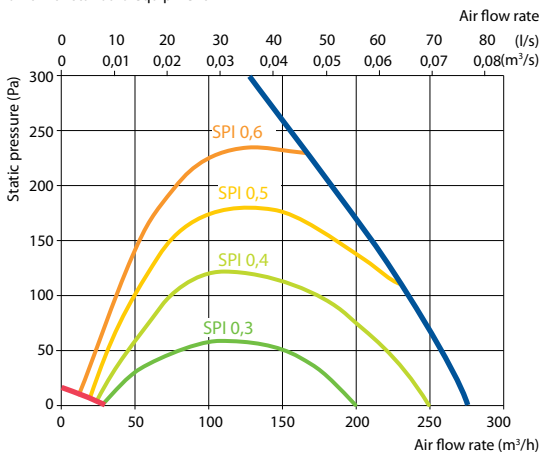

## Accessories

Closing damper	AGUJ-M-125+LF230/CM230
Silencer	A/D AGS-125-50-600-M B/C AGS-125-50-900-M
Water heater	DH-125
PPU	PPU-HW-3R-15-0,4-W2
2-way valve (heater)	VVP47.10-0,4

Water cooler	DCW-0,2-1
2-way valve (cooler)	VVP47.10-1,6
Kitchen hood	KH
Decorative panel	DP
Air distribution box	OSD-200 VE-125
Outdoor grill	LD-125
Water heater-cooler	DHCW-125



# Domekt R 250 F C6

Maximal air flow, m <sup>3</sup> /h	250
Maximal air flow, l/s	69
Unit weight, kg	40
Supply voltage, V	1~230
Maximal operating current, A	HE6,1
Thermal efficiency of heat recovery, %	80
Reference flow rate, m <sup>3</sup> /s	0,049
Reference pressure difference, Pa	50
SPI, W/(m <sup>3</sup> /h)	0,47
Filters dimensions BxHxL, mm	278x258x46
Electric power input of the fan drive at reference flow rate, W	40
Electric power input of the fan drive at maximum flow rate, W	90
Electric air heater capacity, kW / Δt, °C	1/15,9
Maintenance space, mm	300
Control system	C6

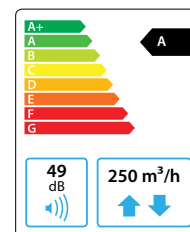

## Acoustic data

A-weighted sound power level L<sub>WA</sub>, dB(A) at reference flow rate

Supply inlet	61
Supply outlet	70
Exhaust inlet	61
Exhaust outlet	70
Casing	49

A-weighted sound pressure level L<sub>PA</sub>, dB(A)

10 m<sup>2</sup> normally isolated room, distance from casing – 3 m.

Surroundings	38
--------------	----

## Performance

Unit with standard equipment

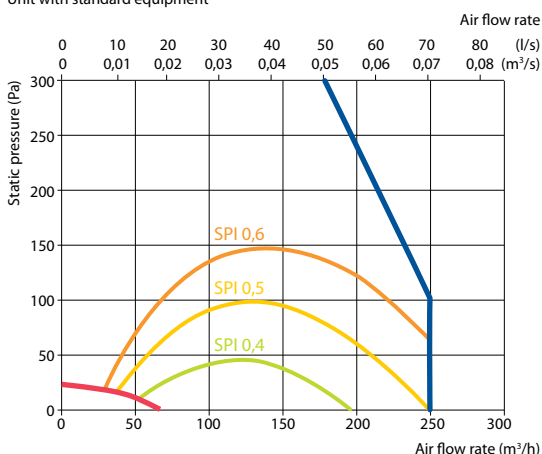

## Temperature efficiency

Outside temperature, °C	Winter					Summer		
	-23	-15	-10	-5	0	25	30	35
After heat exchanger, °C	10,7	12,7	14,0	15,2	16,5	22,8	24,0	25,3

indoor +22°C, 20 % RH

Shown as right (R2)

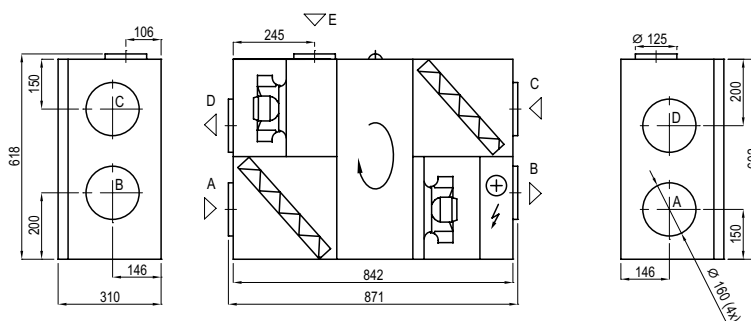

Shown as left (L2)

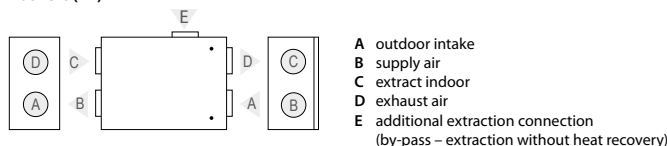

Mounting positions

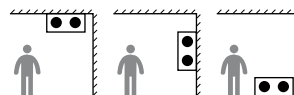

## Accessories

Closing damper	AGUJ-M-160+LF230/CM230
Silencer	A/D AGS-160-50-600-M B/C AGS-160-50-900-M
Water heater	DH-160
PPU	PPU-HW-3R-15-0,4-W2

2-way valve (heater)	VVP47.10-0,4
Water cooler	DCW-0,2-1
2-way valve (cooler)	VVP47.10-1,6
Outdoor grill	LD-160
Water heater-cooler	DHCW-160



# Domekt R 300 V C6

Maximal air flow, m <sup>3</sup> /h	320
Maximal air flow, l/s	89
Unit weight, kg	28
Supply voltage, V	1~230
Maximal operating current, A	HE 4
Thermal efficiency of heat recovery, %	85
Reference flow rate, m <sup>3</sup> /s	0,062
Reference pressure difference, Pa	50
SPI, W/(m <sup>3</sup> /h)	0,28
Filters dimensions B×H×L, mm	290×205×46
Electric power input of the fan drive at reference flow rate, W	30
Electric power input of the fan drive at maximum flow rate, W	72
Electric air heater capacity, kW / Δt, °C	0,5/ 6,2
Maintenance space, mm	450
Control system	C6

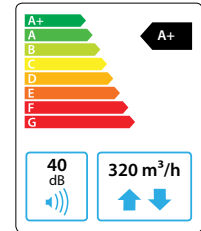

## Acoustic data

A-weighted sound power level  $L_{WA}$ , dB(A) at reference flow rate

Supply inlet	52
Supply outlet	60
Exhaust inlet	52
Exhaust outlet	60
Casing	40

A-weighted sound pressure level  $L_{pA}$ , dB(A)

10 m<sup>2</sup> normally isolated room, distance from casing – 3 m.

Surroundings	30
--------------	----

## Temperature efficiency

Outside temperature, °C	Winter					Summer		
	-23	-15	-10	-5	0	25	30	35
After heat exchanger, °C	15,3	16,5	17,2	18,0	18,7	22,5	23,2	24,0

indoor +22°C, 20 % RH

Shown as left (L1)

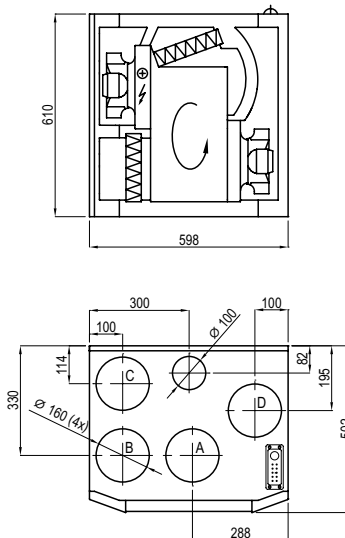

Shown as right (R1)

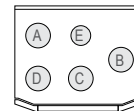

- A outdoor intake
- B supply air
- C extract indoor
- D exhaust air
- E additional extraction connection (by-pass – extraction without heat recovery)

## Performance

Unit with standard equipment

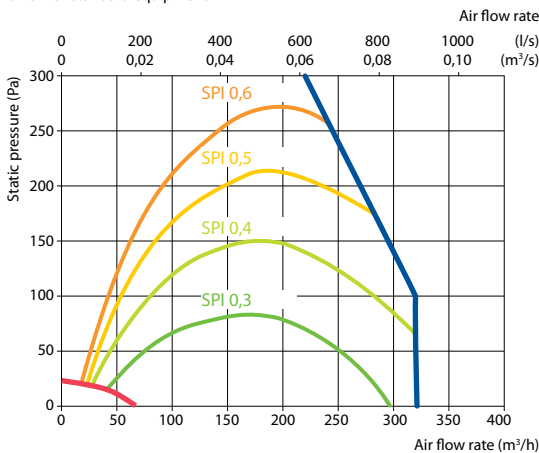

## Accessories

Closing damper	AGUJ-M-160+LF230/CM230
Silencer	A/D AGS-160-50-600-M B/C AGS-160-50-900-M
Water heater	DH-160
PPU	PPU-HW-3R-15-0,4-W2
2-way valve (heater)	VVP47.10-0,4

Water cooler	DCW-0,4-3
2-way valve (cooler)	VVP47.10-1,6
Outdoor grill	LD-160
Water heater-cooler	DHCW-160
DX cooler	DCF-0,4-3
Cooling unit	MOU-12HFN8-KA8140



# Domekt R 400 V C6M

Maximal air flow, m <sup>3</sup> /h	381
Maximal air flow, l/s	106
Unit weight, kg	49
Supply voltage, V	1~230
Maximal operating current, A	HE6,5
Thermal efficiency of heat recovery, %	85
Reference flow rate, m <sup>3</sup> /s	0,074
Reference pressure difference, Pa	50
SPI, W/(m <sup>3</sup> /h)	0,3
Filters dimensions BxHxL, mm	428x231x46
Electric power input of the fan drive at reference flow rate, W	55
Electric power input of the fan drive at maximum flow rate, W	126
Electric air heater capacity, kW / Δt, °C	1 / 7,3
Maintenance space, mm	600
Control system	C6M

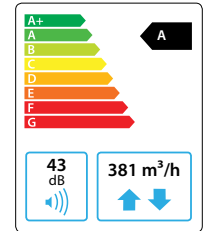

## Acoustic data

A-weighted sound power level  $L_{WA}$ , dB(A) at reference flow rate

Supply inlet	55
Supply outlet	68
Exhaust inlet	55
Exhaust outlet	69
Casing	43

A-weighted sound pressure level  $L_{PA}$ , dB(A)

10 m<sup>2</sup> normally isolated room, distance from casing – 3 m.

Surroundings	33
--------------	----

## Performance

Unit with standard equipment

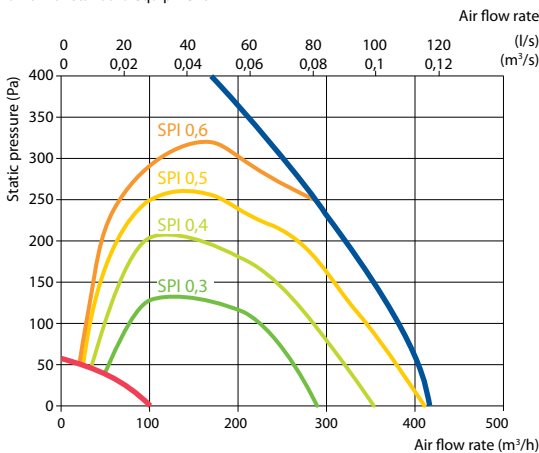

## Temperature efficiency

Outside temperature, °C	Winter					Summer		
	-23	-15	-10	-5	0	25	30	35
After heat exchanger, °C	15,3	16,5	17,2	18	18,7	22,5	23,2	24

indoor +22°C, 20 % RH

Shown as left (L1)

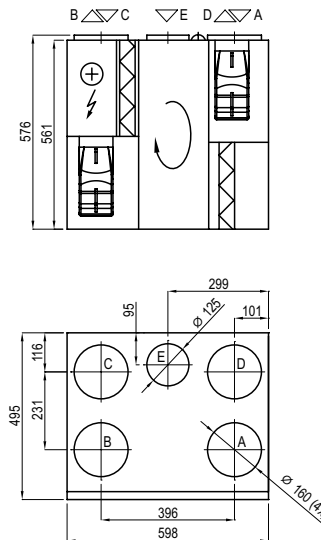

Shown as right (R1)

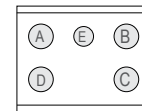

- A outdoor intake
- B supply air
- C extract indoor
- D exhaust air
- E additional extraction connection (by-pass – extraction without heat recovery)

## Accessories

Closing damper	AGUJ-M-160+LF230/CM230
Silencer	A/D AGS-160-50-600-M
	B/C AGS-160-50-900-M
Water heater	DH-160
PPU	PPU-HW-3R-15-0,4-W2
2-way valve (heater)	VVP47.10-0,4

Water cooler	DCW-0,4-3
2-way valve (cooler)	VVP47.10-1,6
Outdoor grill	LD-160
Water heater-cooler	DHCW-160
DX cooler	DCF-0,4-3
Cooling unit	MOU-12HFN8+KA8140





# Domekt R 400 H C6M

Maximal air flow, m <sup>3</sup> /h	460
Maximal air flow, l/s	128
Unit weight, kg	49
Supply voltage, V	1~230
Maximal operating current, A	HE7,3
Thermal efficiency of heat recovery, %	84
Reference flow rate, m <sup>3</sup> /s	0,089
Reference pressure difference, Pa	50
SPI, W/(m <sup>3</sup> /h)	0,27
Filters dimensions BxHxL, mm	417x210x46
Electric power input of the fan drive at reference flow rate, W	45
Electric power input of the fan drive at maximum flow rate, W	113
Electric air heater capacity, kW / Δt, °C	1/6,0
Maintenance space, mm	650
Control system	C6M

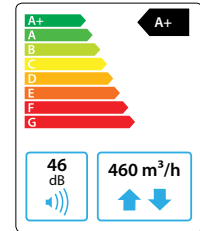

## Acoustic data

A-weighted sound power level  $L_{WA}$ , dB(A) at reference flow rate

Supply inlet	56
Supply outlet	65
Exhaust inlet	56
Exhaust outlet	65
Casing	46

A-weighted sound pressure level  $L_{pA}$ , dB(A)

10 m<sup>2</sup> normally isolated room, distance from casing – 3 m.

Surroundings	34
--------------	----

## Performance

Unit with standard equipment

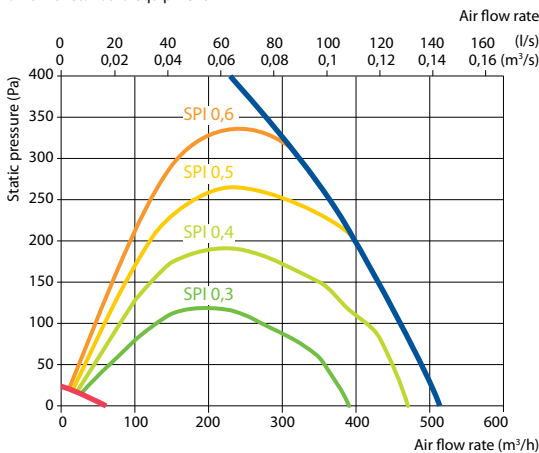

## Temperature efficiency

Outside temperature, °C	Winter					Summer		
	-23	-15	-10	-5	0	25	30	35
After heat exchanger, °C	14,8	16,1	16,9	17,7	18,5	22,5	23,3	24,1

indoor +22°C, 20 % RH

### Shown as right (R1)

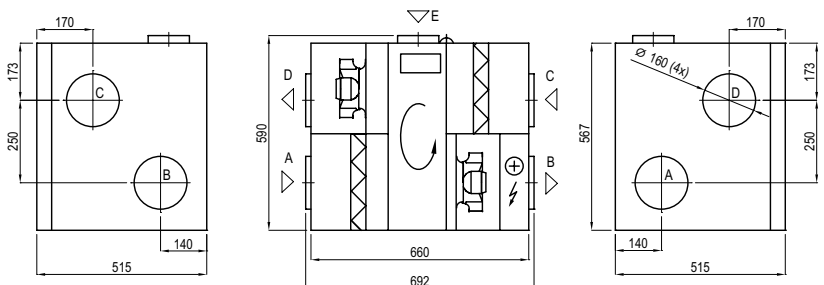

### Shown as left (L1)

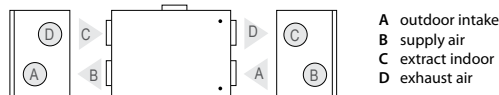

## Accessories

Closing damper	AGUJ-M-160+LF230/CM230
Silencer	A/D AGS-160-50-600-M
	B/C AGS-160-50-900-M
Water heater	DH-160
PPU	PPU-HW-3R-15-0,4-W2
2-way valve (heater)	VVP47.10-0,4

Water cooler	DCW-0,4-3
2-way valve (cooler)	VVP47.10-1,6
Outdoor grill	LD-160
Water heater-cooler	DHCW-160
DX cooler	DCF-0,4-3
Cooling unit	MOU-12HFN8+KA8243



# Domekt R 400 F C6M

Maximal air flow, m <sup>3</sup> /h	452
Maximal air flow, l/s	126
Unit weight, kg	65
Supply voltage, V	1~230
Maximal operating current, A	HE 7,3
Thermal efficiency of heat recovery, %	82
Reference flow rate, m <sup>3</sup> /s	0,088
Reference pressure difference, Pa	50
SPI, W/(m <sup>3</sup> /h)	0,25
Filters dimensions BxHxL, mm	346x258x46
Electric power input of the fan drive at reference flow rate, W	40
Electric power input of the fan drive at maximum flow rate, W	99
Electric air heater capacity, kW / Δt, °C	1 / 8,8
Maintenance space, mm	300
Control system	C6M

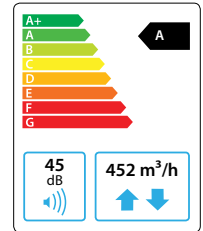

## Acoustic data

A-weighted sound power level  $L_{WA}$ , dB(A) at reference flow rate

Supply inlet	55
Supply outlet	64
Exhaust inlet	55
Exhaust outlet	64
Casing	45

A-weighted sound pressure level  $L_{PA}$ , dB(A)

10 m<sup>2</sup> normally isolated room, distance from casing – 3 m.

Surroundings	33
--------------	----

## Performance

Unit with standard equipment

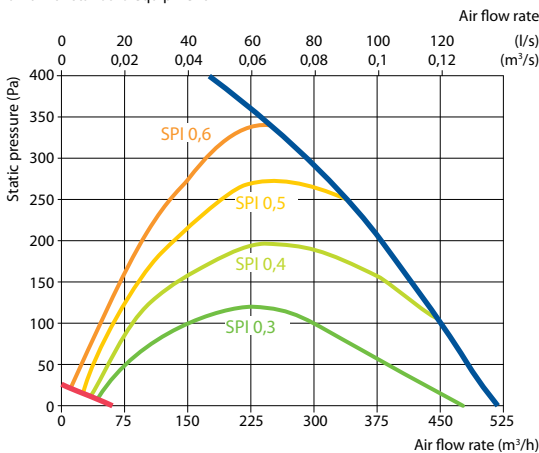

## Temperature efficiency

Outside temperature, °C	Winter					Summer		
	-23	-15	-10	-5	0	25	30	35
After heat exchanger, °C	13,9	15,3	16,2	17,1	18	22,5	23,4	24,3

indoor +22°C, 20 % RH

### Shown as right (R1)

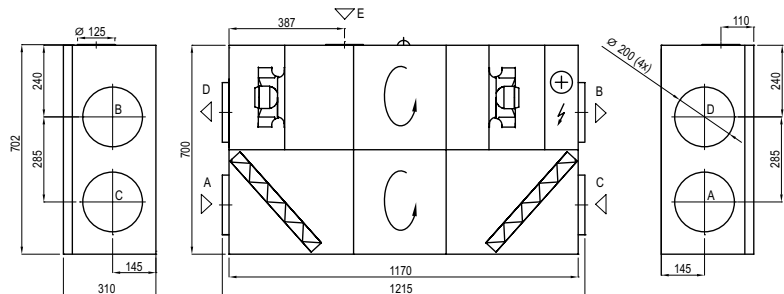

### Shown as left (L1)

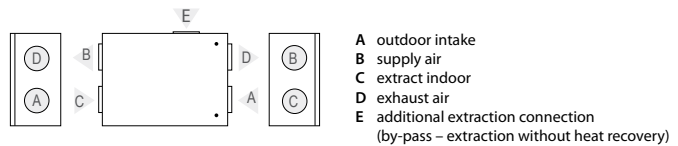

### Mounting positions

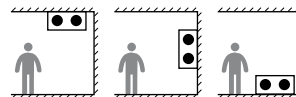

## Accessories

Closing damper	AGUJ-M-200+LF230/CM230
Silencer	A/D AGS-200-50-600-M B/C AGS-200-50-900-M
Water heater	DH-200
PPU	PPU-HW-3R-15-0,63-W2
2-way valve (heater)	VVP47.10-0,63

Water cooler	DCW-0,4-3
2-way valve (cooler)	VVP47.15-2,5
Outdoor grill	LD-200
Water heater-cooler	DHCW-200
DX cooler	DCF-0,4-3
Cooling unit	MOU-12HFN8+KA8140



# Domekt R 450 V C6M

Maximal air flow, m <sup>3</sup> /h	490
Maximal air flow, l/s	136
Unit weight, kg	60
Supply voltage, V	1~230
Maximal operating current, A	HE6,5
Thermal efficiency of heat recovery, %	86
Reference flow rate, m <sup>3</sup> /s	0,095
Reference pressure difference, Pa	50
SPI, W/(m <sup>3</sup> /h)	0,27
Filters dimensions BxHxL, mm	517x278x46
Electric power input of the fan drive at reference flow rate, W	47
Electric power input of the fan drive at maximum flow rate, W	128
Electric air heater capacity, kW / Δt, °C	1 / 8,6
Maintenance space, mm	700
Control system	C6M

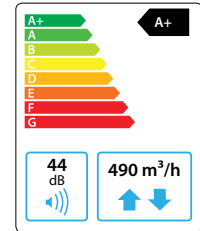

## Acoustic data

A-weighted sound power level  $L_{WA}$ , dB(A) at reference flow rate

Supply inlet	59
Supply outlet	73
Exhaust inlet	59
Exhaust outlet	73
Casing	44

A-weighted sound pressure level  $L_{pA}$ , dB(A)

10 m<sup>2</sup> normally isolated room, distance from casing – 3 m.

Surroundings	33
--------------	----

## Temperature efficiency

Outside temperature, °C	Winter					Summer		
	-23	-15	-10	-5	0	25	30	35
After heat exchanger, °C	15,7	16,8	17,5	18,2	18,9	22,4	23,1	23,8

indoor +22°C, 20 % RH

Shown as left (L1)

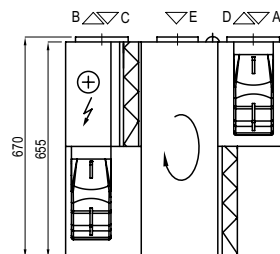

Shown as right (R1)

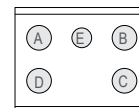

- A outdoor intake
- B supply air
- C extract indoor
- D exhaust air
- E additional extraction connection (by-pass – extraction without heat recovery)

## Performance

Unit with standard equipment

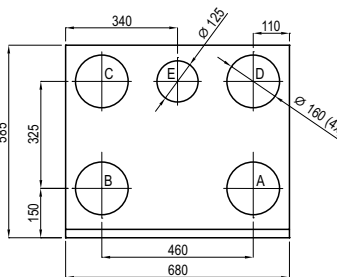
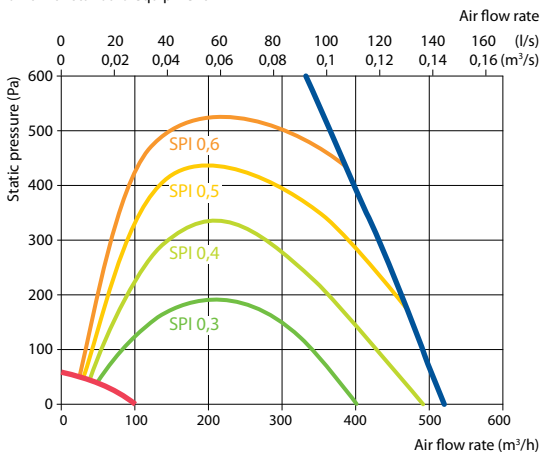

## Accessories

Closing damper	AGUJ-M-160+LF230/CM230
	A/D AGS-160-50-600-M
Silencer	B/C AGS-160-50-900-M
Water heater	DH-160
PPU	PPU-HW-3R-15-0,4-W2
2-way valve (heater)	VVP47.10-0,4

Water cooler	DCW-0,5-3
2-way valve (cooler)	VVP47.10-1,6
Outdoor grill	LD-160
DX cooler	DCF-0,5-3
Cooling unit	MOU-12HFN8+KA8243

C6.1



C6.2



# Domekt R 500 V C6

Maximal air flow, m <sup>3</sup> /h	629
Maximal air flow, l/s	175
Unit weight, kg	113
Supply voltage, V	1~230
Maximal operating current, A	HE 7,3
Thermal efficiency of heat recovery, %	85
Reference flow rate, m <sup>3</sup> /s	0,122
Reference pressure difference, Pa	50
SPI, W/(m <sup>3</sup> /h)	0,21
Filters dimensions BxHxL, mm	540x260x46
Electric power input of the fan drive at reference flow rate, W	47
Electric power input of the fan drive at maximum flow rate, W	107
Electric air heater capacity, kW / Δt, °C	1 / 6,3
Maintenance space, mm	1050
Control system	C6

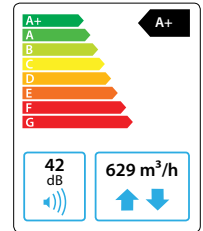

## Acoustic data

A-weighted sound power level  $L_{WA}$ , dB(A) at reference flow rate

Supply inlet	52
Supply outlet	60
Exhaust inlet	52
Exhaust outlet	60
Casing	42

A-weighted sound pressure level  $L_{PA}$ , dB(A)

10 m<sup>2</sup> normally isolated room, distance from casing – 3 m.

Surroundings	31
--------------	----

## Performance

Unit with standard equipment

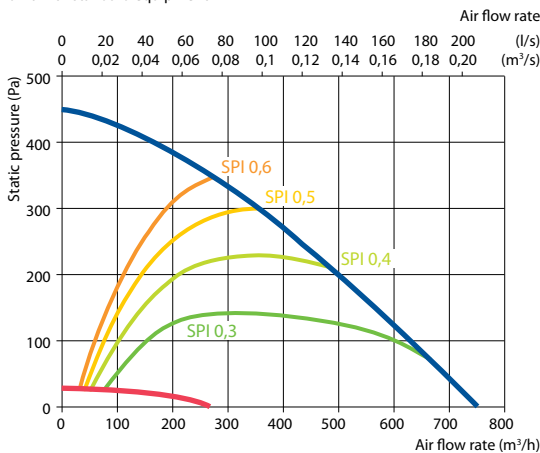

## Temperature efficiency

	Winter					Summer		
Outside temperature, °C	-23	-15	-10	-5	0	25	30	35
After heat exchanger, °C	15,3	16,5	17,2	18	18,7	22,5	23,2	24

indoor +22°C, 20 % RH

Shown as left (L1)

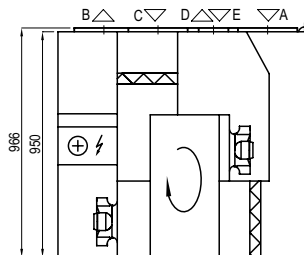

Shown as right (R1)

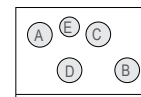

- A outdoor intake
- B supply air
- C extract indoor
- D exhaust air
- E additional extraction connection (by-pass – extraction without heat recovery)

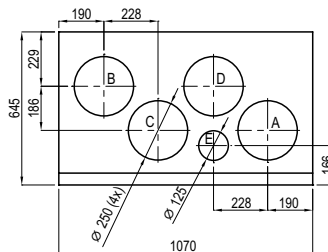

## Accessories

Closing damper	AGUJ-M-250+LF230/CM230
Silencer	A/D AGS-250-50-600-M B/C AGS-250-50-900-M
Water heater	DH-250
PPU	PPU-HW-3R-15-0,63-W2
2-way valve (heater)	VVP47.15-2,5

Water cooler	DCW-0,5-3
2-way valve (cooler)	VVP47.15-2,5
Outdoor grill	LD-250
Water heater-cooler	DHCW-250
DX cooler	DCF-0,5-3
Cooling unit	MOU-12HFN8+KA8140



# Domekt R 600 H C6M

Maximal air flow, m <sup>3</sup> /h	673
Maximal air flow, l/s	187
Unit weight, kg	80
Supply voltage, V	1~230
Maximal operating current, A	HE7,3
Thermal efficiency of heat recovery, %	82
Reference flow rate, m <sup>3</sup> /s	0,131
Reference pressure difference, Pa	50
SPI, W/(m <sup>3</sup> /h)	0,25
Filters dimensions B×H×L, mm	475×235×46
Electric power input of the fan drive at reference flow rate, W	62
Electric power input of the fan drive at maximum flow rate, W	155
Electric air heater capacity, kW / Δt, °C	1 / 5,9
Maintenance space, mm	1100
Control system	C6M



A+  
A  
B  
C  
D  
E  
F  
G

44 dB

673 m<sup>3</sup>/h

## Acoustic data

A-weighted sound power level L<sub>WA</sub>, dB(A) at reference flow rate

Supply inlet	56
Supply outlet	66
Exhaust inlet	56
Exhaust outlet	66
Casing	44

A-weighted sound pressure level L<sub>pA</sub>, dB(A)

10 m<sup>2</sup> normally isolated room, distance from casing – 3 m.

Surroundings	33
--------------	----

## Performance

Unit with standard equipment

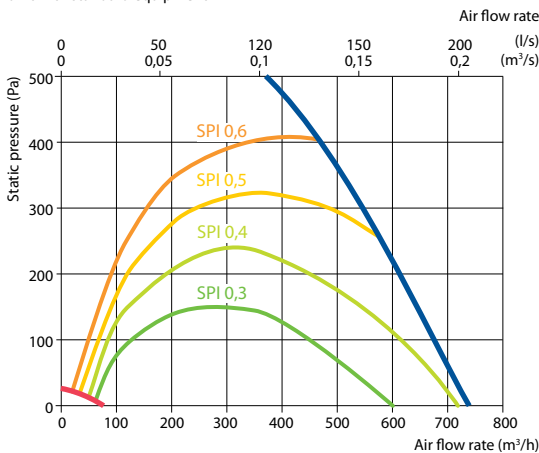

## Temperature efficiency

Outside temperature, °C	Winter					Summer		
	-23	-15	-10	-5	0	25	30	35
After heat exchanger, °C	13,9	15,3	16,2	17,1	18	22,5	23,4	24,3

indoor +22°C, 20 % RH

Shown as right (R1)

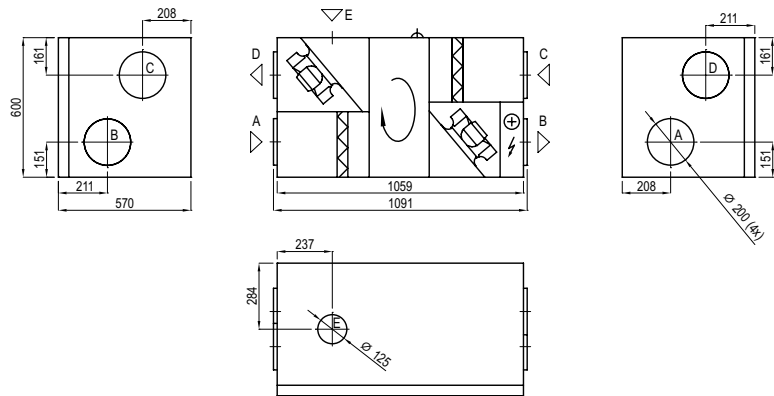

Shown as left (L1)

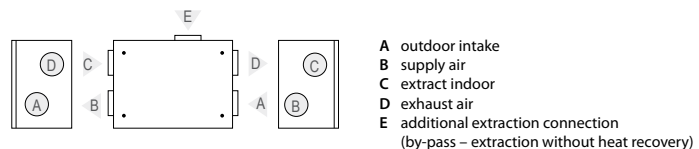

## Accessories

Closing damper	AGUJ-M-200+LF230/CM230
Silencer	A/D AGS-200-50-600-M B/C AGS-200-50-900-M
Water heater	DH-200
PPU	PPU-HW-3R-15-0,63-W2
2-way valve (heater)	VVP47.10-0,63

Water cooler	DCW-0,7-5
2-way valve (cooler)	VVP47.15-2,5
Outdoor grill	LD-200
Water heater-cooler	DHCW-200
DX cooler	DCF-0,7-5
Cooling unit	MOU-18HFN8+KA8140



# Domekt R 700 V C6

Maximal air flow, m <sup>3</sup> /h	764
Maximal air flow, l/s	212
Unit weight, kg	114
Supply voltage, V	1~230
Maximal operating current, A	HE11,7
Thermal efficiency of heat recovery, %	83
Reference flow rate, m <sup>3</sup> /s	0,149
Reference pressure difference, Pa	50
SPI, W/(m <sup>3</sup> /h)	0,26
Filters dimensions BxHxL, mm	540x260x46
Electric power input of the fan drive at reference flow rate, W	73
Electric power input of the fan drive at maximum flow rate, W	179
Electric air heater capacity, kW / Δt, °C	2/10,4
Maintenance space, mm	1050
Control system	C6

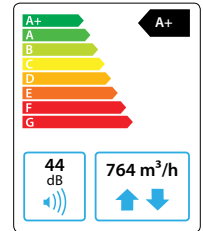

## Acoustic data

A-weighted sound power level L<sub>WA</sub>, dB(A) at reference flow rate

Supply inlet	55
Supply outlet	63
Exhaust inlet	55
Exhaust outlet	63
Casing	44

A-weighted sound pressure level L<sub>PA</sub>, dB(A)

10 m<sup>2</sup> normally isolated room, distance from casing – 3 m.

Surroundings	34
--------------	----

## Performance

Unit with standard equipment

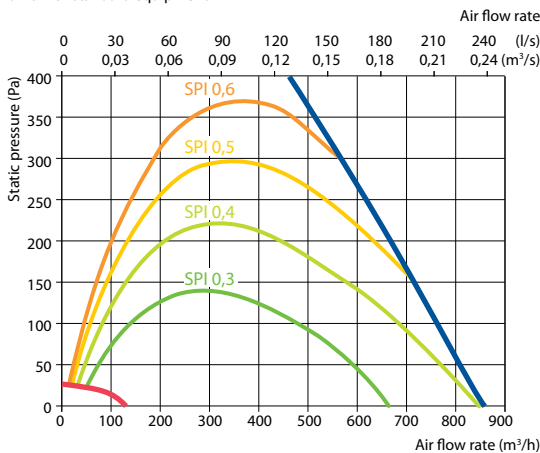

## Temperature efficiency

	Winter					Summer		
Outside temperature, °C	-23	-15	-10	-5	0	25	30	35
After heat exchanger, °C	13,1	14,7	15,7	16,7	17,7	22,6	23,6	24,6

indoor +22°C, 20 % RH

Shown as left (L1)

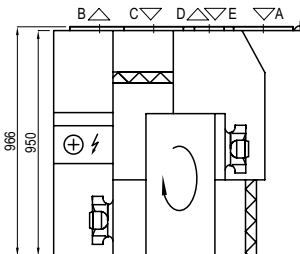

Shown as right (R1)

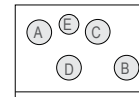

- A outdoor intake
- B supply air
- C extract indoor
- D exhaust air
- E additional extraction connection (by-pass – extraction without heat recovery)

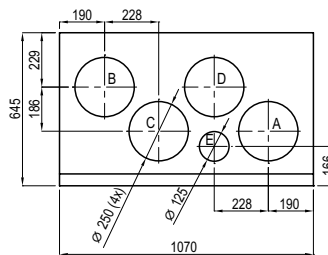

## Accessories

Closing damper	AGUJ-M-250+LF230/CM230
Silencer	A/D AGS-250-50-600-M B/C AGS-250-50-900-M
Water heater	DH-250
PPU	PPU-HW-3R-15-0,63-W2
2-way valve (heater)	VVP47.10-0,63

Water cooler	DCW-0,7-5
2-way valve (cooler)	VVP47.15-2,5
Outdoor grill	LD-250
Water heater-cooler	DHCW-250
DX cooler	DCF-0,7-5
Cooling unit	MOU-18HFN8+KA8140



# Domekt R 700 H C6

Maximal air flow, m <sup>3</sup> /h	696
Maximal air flow, l/s	193
Unit weight, kg	87
Supply voltage, V	1~230
Maximal operating current, A	HE 11,7
Thermal efficiency of heat recovery, %	84
Reference flow rate, m <sup>3</sup> /s	0,135
Reference pressure difference, Pa	50
SPI, W/(m <sup>3</sup> /h)	0,34
Filters dimensions B×H×L, mm	540×260×46
Electric power input of the fan drive at reference flow rate, W	89
Electric power input of the fan drive at maximum flow rate, W	176
Electric air heater capacity, kW / Δt, °C	2 / 11,4
Maintenance space, mm	950
Control system	C6

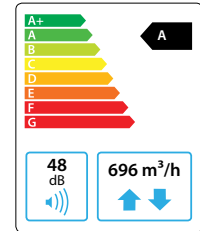

## Acoustic data

A-weighted sound power level  $L_{WA}$ , dB(A) at reference flow rate

Supply inlet	60
Supply outlet	69
Exhaust inlet	60
Exhaust outlet	69
Casing	48

A-weighted sound pressure level  $L_{pA}$ , dB(A)

10 m<sup>2</sup> normally isolated room, distance from casing – 3 m.

Surroundings	37
--------------	----

## Temperature efficiency

Outside temperature, °C	Winter					Summer		
	-23	-15	-10	-5	0	25	30	35
After heat exchanger, °C	13,6	15,1	16,0	16,9	17,9	22,6	23,5	24,4

indoor +22°C, 20 % RH

Shown as right (R1)

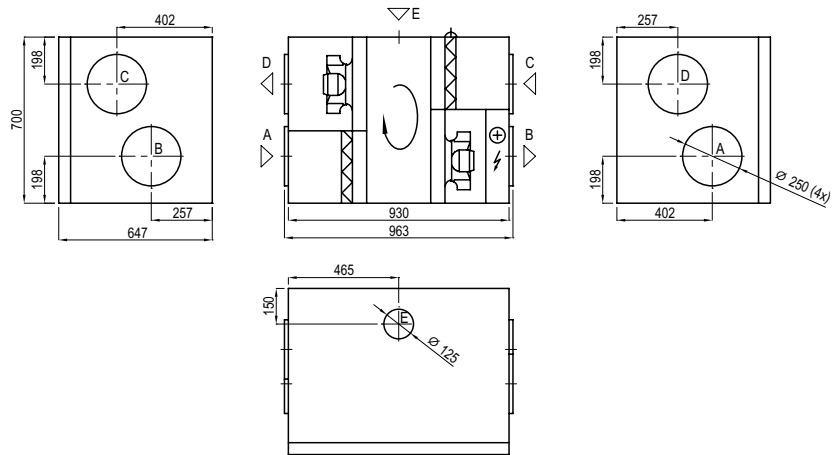

Shown as left (L1)

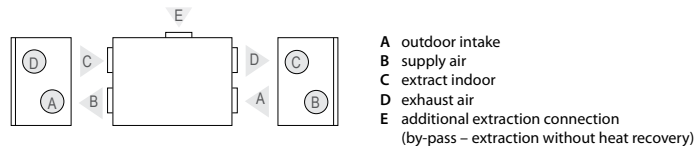

## Performance

Unit with standard equipment

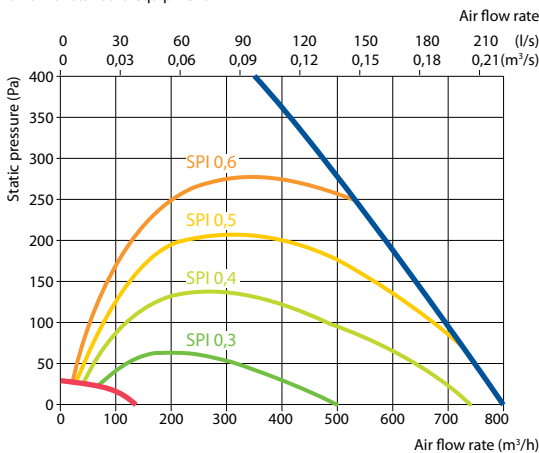

## Accessories

Closing damper	AGUJ-M-250+LF230/CM230
	A/D AGS-250-50-600-M
Silencer	B/C AGS-250-50-900-M
Water heater	DH-250
PPU	PPU-HW-3R-15-0,63-W2
2-way valve (water heater)	VVP47.10-0,63

Water cooler	DCW-0,7-5
2-way valve (water cooler)	VVP47.15-2,5
Outdoor grill	LD-250
Water heater-cooler	DHCW-250
DX cooler	DCF-0,7-5
Cooling unit	MOU-18HFN8+KA8140



# Domekt R 700 F C6

Maximal air flow, m <sup>3</sup> /h	686
Maximal air flow, l/s	191
Unit weight, kg	93
Supply voltage, V	1~230
Maximal operating current, A	HE11,7
Thermal efficiency of heat recovery, %	83
Reference flow rate, m <sup>3</sup> /s	0,133
Reference pressure difference, Pa	50
SPI, W/(m <sup>3</sup> /h)	0,30
Filters dimensions BxHxL, mm	370x360x46
Electric power input of the fan drive at reference flow rate, W	76
Electric power input of the fan drive at maximum flow rate, W	176
Electric air heater capacity, kW / Δt, °C	2/11,6
Maintenance space, mm	430
Control system	C6

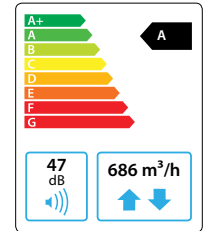

## Acoustic data

A-weighted sound power level  $L_{WA}$ , dB(A) at reference flow rate

Supply inlet	54
Supply outlet	67
Exhaust inlet	54
Exhaust outlet	67
Casing	47

A-weighted sound pressure level  $L_{PA}$ , dB(A)

10 m<sup>2</sup> normally isolated room, distance from casing – 3 m.

Surroundings	36
--------------	----

## Performance

Unit with standard equipment

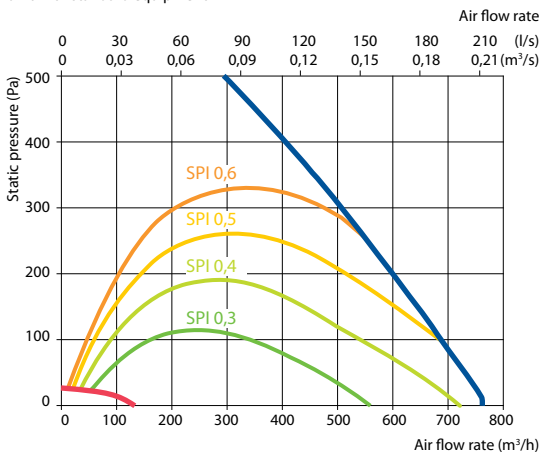

## Temperature efficiency

Outside temperature, °C	Winter					Summer		
	-23	-15	-10	-5	0	25	30	35
After heat exchanger, °C	12,6	14,3	15,3	16,4	17,4	22,6	23,7	24,7

indoor +22°C, 20 % RH

### Shown as left (L1)

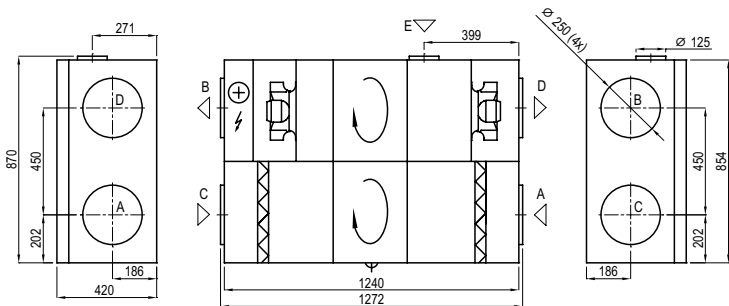

### Shown as right (R1)

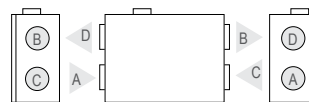

- A outdoor intake
- B supply air
- C extract indoor
- D exhaust air
- E additional extraction connection (by-pass – extraction without heat recovery)

### Mounting positions

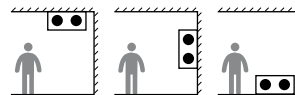

## Accessories

Closing damper	AGUJ-M-250+LF230/CM230
Silencer	A/D AGS-250-50-600-M
	B/C AGS-250-50-900-M
Water heater	DH-250
PPU	PPU-HW-3R-15-0,63-W2
2-way valve (heater)	VVP47.10-0,63

Water cooler	DCW-0,7-5
2-way valve (cooler)	VVP47.15-2,5
Outdoor grill	LD-250
Water heater-cooler	DHCW-250
DX cooler	DCF-0,7-5
Cooling unit	MOU-18HFN8+KA8140

